



Payroll Bridge

Streamlined Contribution Processing Payroll Bridge Program

Traditionally, plan sponsors often act as the middleman between their payroll vendor and their recordkeeper to ensure that each has the needed information to keep things running smoothly. This can mean collecting and distributing the same information multiple times — when processing contributions each payroll cycle and when completing other critical tasks, such as compliance testing and eligibility reporting. Fortunately, FASCore, LLC has a more efficient and effective alternative.

With FASCore’s Payroll Bridge program, you can significantly streamline contribution processing by reducing your middleman role in the transmission of contribution information. As its name implies, Payroll Bridge directly connects your payroll vendor and FASCore — in essence, building a bridge that allows them to exchange contribution information automatically.

Rather than entering contribution data separately — or maintaining a separate file for contributions in addition to your payroll submission — you simply submit your information to your payroll vendor, and your payroll vendor transmits the relevant contribution data directly to FASCore.

The bottom line? Payroll Bridge transforms contribution processing by making it:

- » **Simple** – Reducing the redundancy in gathering and submitting contribution data
- » **Secure** – Ensuring the safe transmission of sensitive participant and contribution data
- » **Automated** – Freeing you to devote more time to address participant needs and questions

Without Payroll Bridge Program

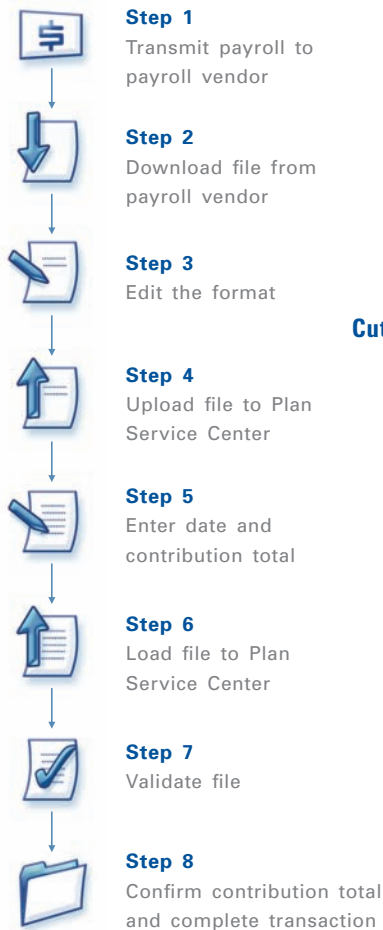

Cut Your Time in Half!



WITH Payroll Bridge Program

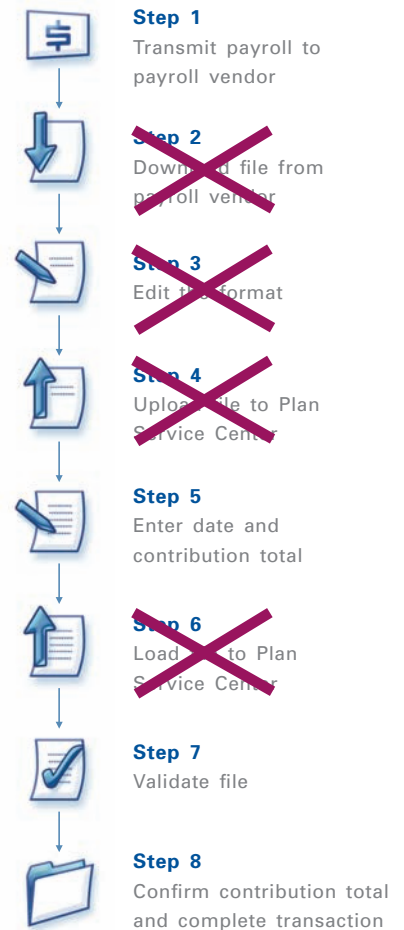

Streamlined Contribution Processing Payroll Bridge Program *(continued)*

Payroll Bridge focuses your involvement in contribution processing on those steps that require your review and approval. In short, you retain oversight and control of the process, but save valuable time by reducing the number of steps you participate in.

Building a Bridge to New Capabilities

The advantages of the Payroll Bridge program don't stop with contribution processing. The participant indicative data we receive from Payroll Bridge lays the groundwork for a host of other benefits. The opportunities include:

-
- » **Easier compliance testing**
 - » **Timely vesting and eligibility updates**
 - » **Improved salary deferral analysis and tracking**
 - » **Streamlined loan administration**
 - » **Targeted marketing campaigns**
-

To find out more about how Payroll Bridge can dramatically simplify your contribution processing—and open the door to a wider range of benefits—contact a FASCore representative.